



THE STRENGTH WITHIN

# C JOIST SPAN TABLES AND DETAILS



MONTREAL • TORONTO • CALGARY • EDMONTON • VANCOUVER

**BAILEY**<sup>®</sup>  
METAL PRODUCTS LIMITED



# FLOOR JOISTS

Bailey Lightweight Steel Framing (LSF) Joists offer a wide range of span and load capabilities for commercial and residential floor systems and mezzanines. The use of Bailey LSF Joist Rafter members will provide support for interior drywall ceilings where long clear spans are required.

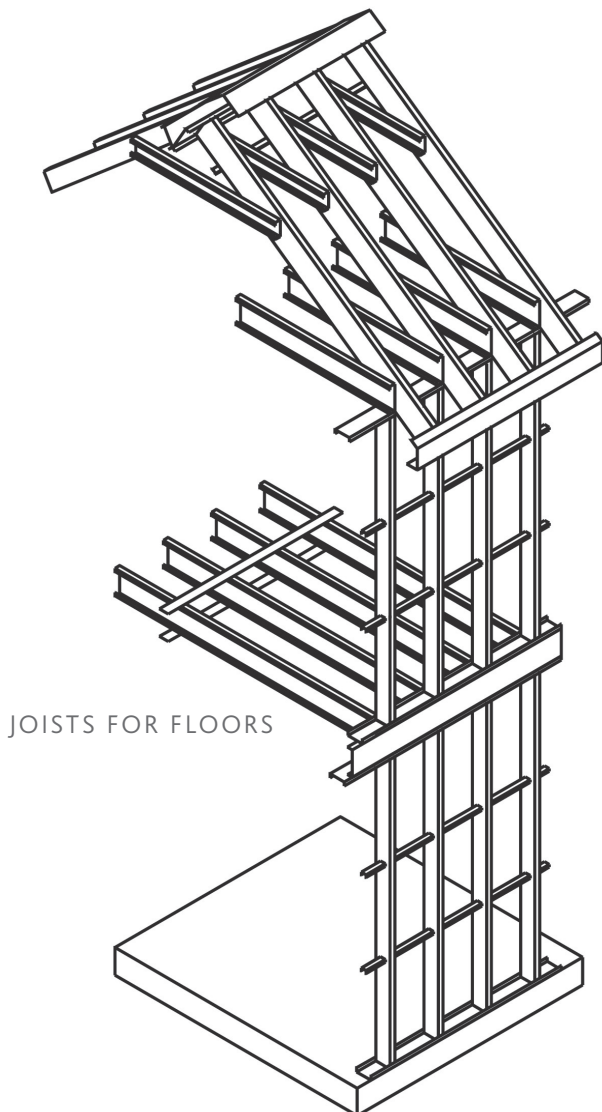

## FLOOR JOIST WITH BRIDGING AND BLOCKING

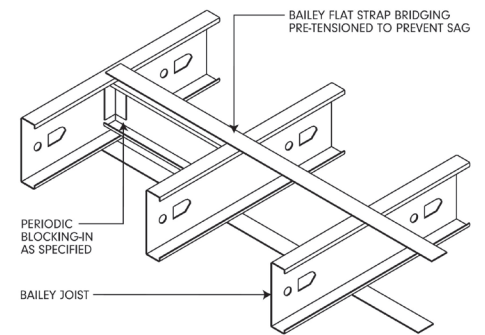

## JOISTS CONTINUOUS OVER SUPPORTING BEAM

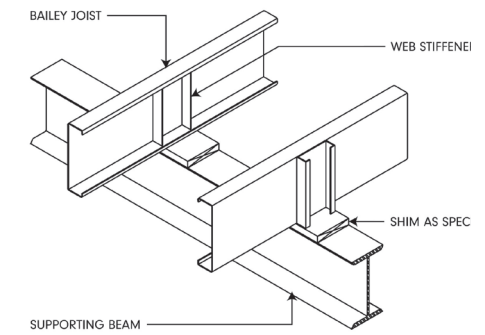

## JOIST PARALLEL TO PERIMETER

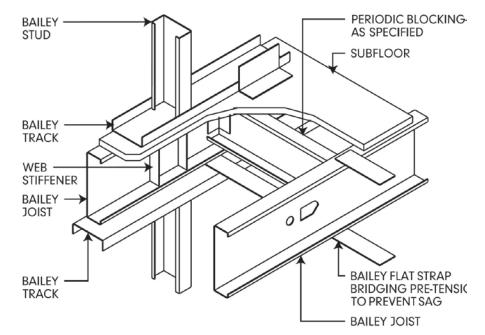



# BAILEY

METAL PRODUCTS LIMITED

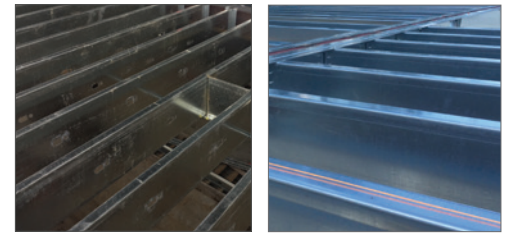

FLOOR MOUNTED INSIDE CONCRETE WALL

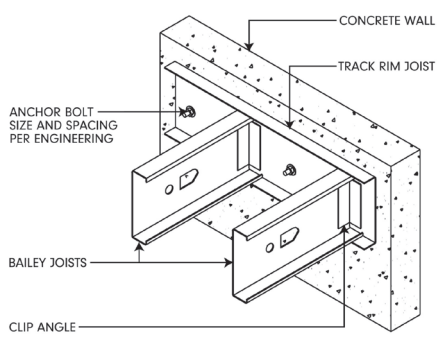

OPENING IN FLOOR

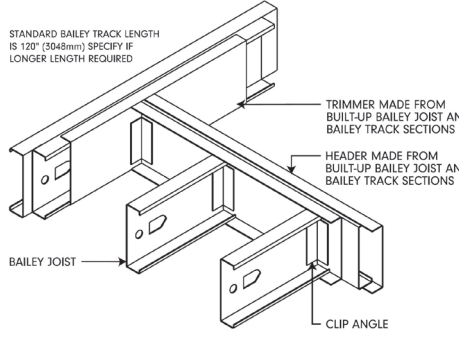

FLUSH CONNECTION TO SUPPORTING BEAM

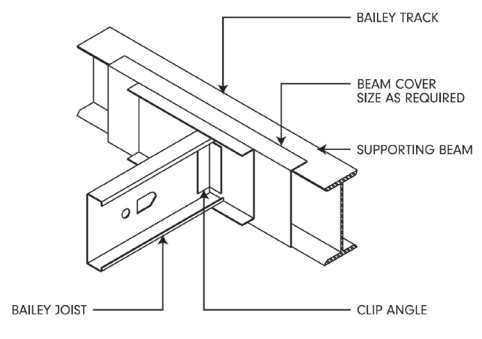

JOISTS OVERLAPPING SUPPORTING BEAM

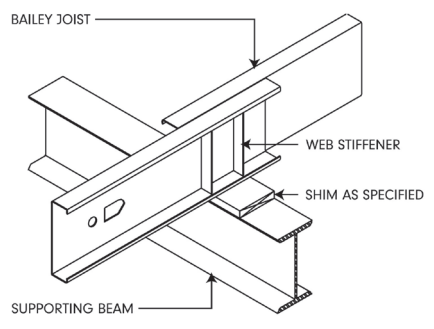

JOIST PERPENDICULAR TO PERIMETER

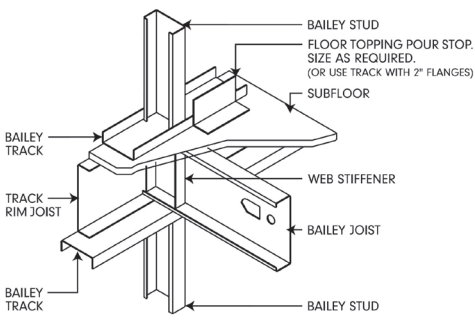

JOIST ABOVE LOADBEARING WALL

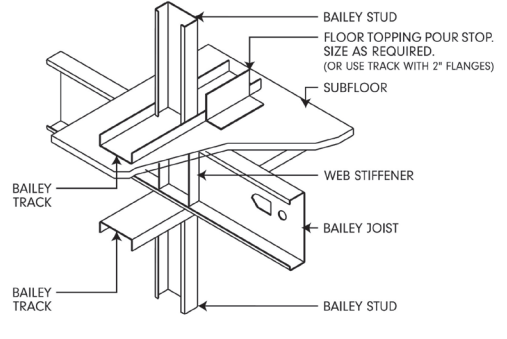

JOIST PERPENDICULAR TO PERIMETER

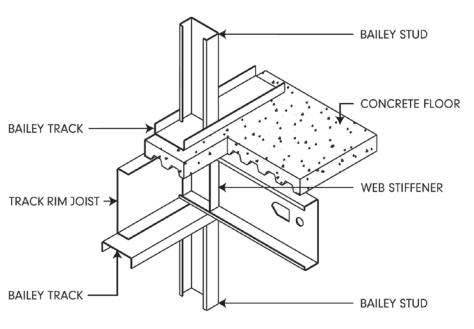

JOIST ABOVE LOADBEARING WALL

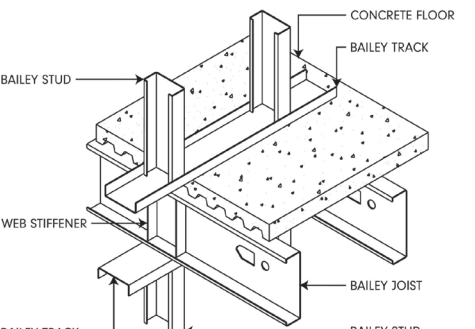

JOIST PARALLEL TO PERIMETER

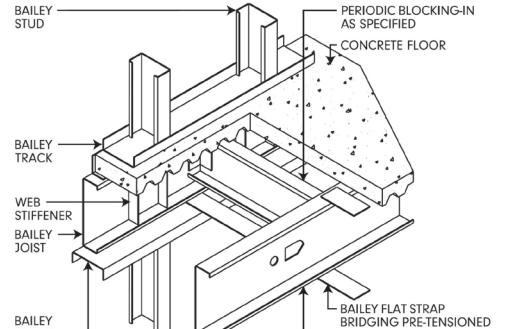

# FLOOR JOIST SPAN LIMITATIONS

Joist Member	Yield Strength Fy(ksi)	15 psf Dead Load 40 psf Live Load					
		TL Deflection = L/240, LL Deflection = L/360			TL Deflection = L/240, LL Deflection = L/480		
		Spacing (in) o.c.			Spacing (in) o.c.		
		12	16	24	12	16	24
800S162-43	33	14.9	12.9	10.6	14.9	12.9	10.6
800S162-54	50	18.1	16.5	14.1	16.5	14.9	13.1
800S162-68	50	19.6	17.8	15.6	17.8	16.2	14.2
800S162-97	50	21.8	19.8	17.4	19.8	18	15.7
800S200-43	33	16	13.8	11.3	16	13.8	11.3
800S200-54	50	19.1	17.4	15.1	17.5	15.8	13.8
800S200-68	50	20.6	18.7	16.4	18.7	17	14.8
800S200-97	50	23	20.8	18.1	20.8	18.9	16.5
800S250-43	33	16.4	14.2	11.6	16.4	14.2	11.6
800S250-54	50	19.8	18	15.4	17.9	16.3	14.2
800S250-68	50	21.5	19.5	17	19.5	17.7	15.5
800S250-97	50	24	21.8	19	21.8	19.8	17.2
800S300-43	33	16.6	14.4	11.8	16.6	14.4	11.8
800S300-54	50	20.2	18.3	15.6	18.4	16.7	14.6
800S300-68	50	22	20	17.4	19.9	18.1	15.8
800S300-97	50	24.8	22.5	19.6	22.5	20.4	17.8
1000S162-54	50	21.6	19.1	15.6	19.6	17.8	15.6
1000S162-68	50	23.4	21.3	18.4	21.3	19.3	16.8
1000S162-97	50	26.4	24	20.8	23.9	21.8	18.9
1000S200-54	50	22.6	20.5	16.9	20.5	18.6	16.2
1000S200-68	50	24.4	22.2	19.5	22.2	20.2	17.6
1000S200-97	50	27.5	25	21.8	24.9	22.7	19.8
1000S250-54	50	23.6	21.2	17.3	21.4	19.5	17
1000S250-68	50	25.6	23.2	20.3	23.2	21	18.5
1000S250-97	50	28.7	26	22.8	26.1	23.6	20.7
1000S300-54	50	24	21.6	17.5	21.8	19.8	17.2
1000S300-68	50	26.2	23.8	20.7	23.8	21.6	18.8
1000S300-97	50	29.5	26.8	23.4	26.8	24.4	21.3
1200S162-68	50	27	24.5	20	24.5	22.3	19.5
1200S162-97	50	30.5	27.8	24.2	27.7	25.2	22
1200S200-68	50	28.2	25.6	21.6	25.6	23.2	20.3
1200S200-97	50	32	29	25.2	28.9	26.2	22.9
1200S250-68	50	29	26.5	22.3	26.4	24	20.9
1200S250-97	50	33	30	26.2	30.1	27.3	23.9
1200S300-68	50	30.2	27.5	22.7	27.6	24.9	21.8
1200S300-97	50	34.2	31	27	31.1	28.2	24.6
1400S162-68	50	30	26	21.1	27.6	25.1	21.1
1400S162-97	50	34.6	31.5	27.5	31.5	28.6	24.9
1400S200-68	50	31.7	28.2	23.1	28.7	26.1	22.8
1400S200-97	50	36	32.7	28.6	32.7	29.7	25.9
1400S250-68	50	32.7	29.4	24	29.7	26.9	23.6
1400S250-97	50	37.3	34	29.7	33.9	30.9	26.9
1400S300-68	50	33.3	30	24.5	30.3	27.6	24
1400S300-97	50	38.3	34.7	30.5	34.9	31.7	27.6

1. Spans are based on continuous support of compression flange over the full length of the joist.
2. Joist deflection limitations are based upon L/240 for the total load (TL) and L/360 or L/480 for live load (LL).
3. Joists must be braced against rotation at all supports.
4. The yield stress (33ksi or 50ksi) used to calculate tabulated values is indicated in each table.
5. Span tables are calculated per CSSBI 58-2018 Lightweight Steel Framing Member Selection Tables.
6. Stud distortional buckling based on an assumed  $K\phi=0$ .
7. Web punchouts are not considered for shear.
8. The tables do not include web crippling calculations. Web crippling and web stiffeners requirements to be designed as per CSSBI 58-2018 and Section G-5 of S136-16.

# FLOOR JOIST SPAN LIMITATIONS

Joist Member	Yield Strength Fy(ksi)	25 psf Dead Load 40 psf Live Load					
		TL Deflection = L/240, LL Deflection = L/360			TL Deflection = L/240, LL Deflection = L/480		
		Spacing (in) o.c.			Spacing (in) o.c.		
		12	16	24	12	16	24
800S162-43	33	13.9	12	9.8	13.9	12	9.8
800S162-54	50	17.7	15.9	13	16.5	14.9	13
800S162-68	50	19.1	17.3	15.2	17.8	16.2	14.2
800S162-97	50	21.2	19.3	16.9	19.8	18	15.7
800S200-43	33	14.9	12.9	10.5	14.9	12.9	10.5
800S200-54	50	18.7	16.9	14	17.5	15.8	13.8
800S200-68	50	20.1	18.2	15.9	18.7	17	14.8
800S200-97	50	22.3	20.2	17.7	20.8	18.9	16.5
800S250-43	33	15.3	13.2	10.8	15.3	13.2	10.8
800S250-54	50	19.2	17.5	14.3	17.9	16.3	14.2
800S250-68	50	20.9	18.9	16.5	19.5	17.7	15.5
800S250-97	50	23.3	21.2	18.5	21.8	19.8	17.2
800S300-43	33	15.4	13.4	10.9	15.4	13.4	10.9
800S300-54	50	19.6	17.7	14.5	18.4	16.7	14.5
800S300-68	50	21.4	19.4	16.9	19.9	18.1	15.8
800S300-97	50	24.1	21.9	19.1	22.5	20.4	17.8
1000S162-54	50	20.5	17.7	14.5	19.6	17.7	14.5
1000S162-68	50	22.7	20.7	17.1	21.3	19.3	16.8
1000S162-97	50	25.7	23.3	20.3	23.9	21.8	18.9
1000S200-54	50	21.9	19.1	15.7	20.5	18.6	15.7
1000S200-68	50	23.7	21.6	18.4	22.2	20.2	17.6
1000S200-97	50	26.7	24.3	21.2	24.9	22.7	19.8
1000S250-54	50	22.8	19.7	16.1	21.4	19.5	16.1
1000S250-68	50	24.9	22.6	18.9	23.2	21	18.5
1000S250-97	50	27.9	25.3	22.1	26.1	23.6	20.7
1000S300-54	50	23.1	19.9	16.3	21.8	19.8	16.3
1000S300-68	50	25.5	23.1	19.3	23.8	21.6	18.8
1000S300-97	50	28.7	26.1	22.7	26.8	24.4	21.3
1200S162-68	50	26.2	22.7	18.5	24.5	22.3	18.5
1200S162-97	50	29.7	27.1	23.6	27.7	25.2	22
1200S200-68	50	27.4	24.5	20	25.6	23.2	20
1200S200-97	50	31.1	28.1	24.6	28.9	26.2	22.9
1200S250-68	50	28.3	25.5	20.7	26.4	24	20.7
1200S250-97	50	32.1	29.3	25.5	30.1	27.3	23.9
1200S300-68	50	29.5	25.8	21	27.6	24.9	21
1200S300-97	50	33.2	30.1	26.3	31.1	28.2	24.6
1400S162-68	50	27.8	24.1	19.7	27.6	24.1	19.7
1400S162-97	50	33.6	30.6	25.8	31.5	28.6	24.9
1400S200-68	50	30.4	26.2	21.4	28.7	26.1	21.4
1400S200-97	50	35.1	31.9	27.8	32.7	29.7	25.9
1400S250-68	50	31.6	27.2	22.3	29.7	26.9	22.3
1400S250-97	50	36.4	32.9	28.8	33.9	30.9	26.9
1400S300-68	50	32.2	27.9	22.8	30.3	27.6	22.8
1400S300-97	50	37.2	33.9	29.5	34.9	31.7	27.6

1. Spans are based on continuous support of compression flange over the full length of the joist.
2. Joist deflection limitations are based upon L/240 for the total load (TL) and L/360 or L/480 for live load (LL).
3. Joists must be braced against rotation at all supports.
4. The yield stress (33ksi or 50ksi) used to calculate tabulated values is indicated in each table.
5. Span tables are calculated per CSSBI 58-2018 Lightweight Steel Framing Member Selection Tables.
6. Stud distortional buckling based on an assumed  $K\phi=0$ .
7. Web punchouts are not considered for shear.
8. The tables do not include web crippling calculations. Web crippling and web stiffeners requirements to be designed as per CSSBI 58-2018 and Section G-5 of S136-16.

# FLOOR JOIST SPAN LIMITATIONS

Joist Member	Yield Strength Fy(ksi)	35 psf Dead Load 40 psf Live Load					
		TL Deflection = L/240, LL Deflection = L/360			TL Deflection = L/240, LL Deflection = L/480		
		Spacing (in) o.c.			Spacing (in) o.c.		
		12	16	24	12	16	24
800S162-43	33	13	11.3	9.2	13	11.3	9.2
800S162-54	50	16.9	15	12.3	16.5	14.9	12.3
800S162-68	50	18.2	16.6	14.3	17.8	16.2	14.2
800S162-97	50	20.2	18.5	16.1	19.8	18	15.7
800S200-43	33	13.9	12	9.8	13.9	12	9.8
800S200-54	50	17.8	16.1	13.1	17.5	15.8	13.1
800S200-68	50	19.1	17.4	15.2	18.7	17	14.8
800S200-97	50	21.2	19.3	16.9	20.8	18.9	16.5
800S250-43	33	14.3	12.4	10.1	14.3	12.4	10.1
800S250-54	50	18.3	16.5	13.4	17.9	16.3	13.4
800S250-68	50	19.8	18.1	15.8	19.5	17.7	15.5
800S250-97	50	22.2	20.2	17.6	21.8	19.8	17.2
800S300-43	33	14.5	12.6	10.3	14.5	12.6	10.3
800S300-54	50	18.7	16.7	13.6	18.4	16.7	13.6
800S300-68	50	20.4	18.5	16	19.9	18.1	15.8
800S300-97	50	23	20.8	18.2	22.5	20.4	17.8
1000S162-54	50	19.3	16.7	13.6	19.3	16.7	13.6
1000S162-68	50	21.7	19.7	16.1	21.3	19.3	16.1
1000S162-97	50	24.5	22.2	19.4	23.9	21.8	18.9
1000S200-54	50	20.8	18	14.7	20.5	18	14.7
1000S200-68	50	22.7	20.7	17.2	22.2	20.2	17.2
1000S200-97	50	25.5	23.1	20.2	24.9	22.7	19.8
1000S250-54	50	21.4	18.5	15.1	21.4	18.5	15.1
1000S250-68	50	23.8	21.5	17.7	23.2	21	17.7
1000S250-97	50	26.6	24.1	21.1	26.1	23.6	20.7
1000S300-54	50	21.7	18.7	15.3	21.7	18.7	15.3
1000S300-68	50	24.3	22.1	18	23.8	21.6	18
1000S300-97	50	27.4	25	21.7	26.8	24.4	21.3
1200S162-68	50	24.6	21.3	17.4	24.5	21.3	17.4
1200S162-97	50	28.4	25.8	22.5	27.7	25.2	22
1200S200-68	50	26.1	23	18.8	25.6	23	18.8
1200S200-97	50	29.6	26.8	23.5	28.9	26.2	22.9
1200S250-68	50	27	23.9	19.5	26.4	23.9	19.5
1200S250-97	50	30.8	28	24.4	30.1	27.3	23.9
1200S300-68	50	28	24.2	19.8	27.6	24.2	19.8
1200S300-97	50	31.8	28.8	25.1	31.1	28.2	24.6
1400S162-68	50	26.1	22.6	18.5	26.1	22.6	18.5
1400S162-97	50	32.2	29.2	24.1	31.5	28.6	24.1
1400S200-68	50	28.4	24.6	20.1	28.4	24.6	20.1
1400S200-97	50	33.5	30.4	26.1	32.7	29.7	25.9
1400S250-68	50	29.6	25.6	20.9	29.6	25.6	20.9
1400S250-97	50	34.7	31.6	27	33.9	30.9	26.9
1400S300-68	50	30.2	26.1	21.4	30.2	26.1	21.4
1400S300-97	50	35.6	32.4	27.7	34.9	31.7	27.6

1. Spans are based on continuous support of compression flange over the full length of the joist.
2. Joist deflection limitations are based upon L/240 for the total load (TL) and L/360 or L/480 for live load (LL).
3. Joists must be braced against rotation at all supports.
4. The yield stress (33ksi or 50ksi) used to calculate tabulated values is indicated in each table.
5. Span tables are calculated per CSSBI 58-2018 Lightweight Steel Framing Member Selection Tables.
6. Stud distortional buckling based on an assumed  $K\phi=0$ .
7. Web punchouts are not considered for shear.
8. The tables do not include web crippling calculations. Web crippling and web stiffeners requirements to be designed as per CSSBI 58-2018 and Section G-5 of S136-16.

# FLOOR JOIST SPAN LIMITATIONS

Joist Member	Yield Strength F <sub>y</sub> (ksi)	15 psf Dead Load 100 psf Live Load					
		TL Deflection = L/240, LL Deflection = L/360			TL Deflection = L/240, LL Deflection = L/480		
		Spacing (in) o.c.			Spacing (in) o.c.		
		12	16	24	12	16	24
800S162-43	33	10.2	8.8	0	10.2	8.8	0
800S162-54	50	13.4	11.8	9.6	12.2	11	9.6
800S162-68	50	14.5	13.2	11.2	13.2	11.9	10.5
800S162-97	50	16.1	14.7	12.8	14.7	13.3	11.6
800S200-43	33	10.9	9.5	0	10.9	9.5	0
800S200-54	50	14.2	12.6	10.3	12.9	11.7	10.2
800S200-68	50	15.2	13.8	12	13.8	12.6	10.9
800S200-97	50	16.9	15.4	13.5	15.4	13.9	12.2
800S250-43	33	11.2	9.7	0	11.2	9.7	0
800S250-54	50	14.6	12.9	10.6	13.2	12	10.5
800S250-68	50	15.8	14.4	12.3	14.4	13	11.4
800S250-97	50	17.7	16.1	14	16.1	14.6	12.7
800S300-43	33	11.4	9.9	0	11.4	9.9	0
800S300-54	50	14.9	13.1	10.7	13.6	12.3	10.7
800S300-68	50	16.2	14.7	12.6	14.7	13.4	11.7
800S300-97	50	18.3	16.6	14.5	16.6	15.1	13.2
1000S162-54	50	15.1	13.1	10.7	14.5	13.1	10.7
1000S162-68	50	17.3	15.4	12.6	15.7	14.3	12.5
1000S162-97	50	19.4	17.7	15.4	17.6	16	14
1000S200-54	50	16.3	14.1	11.5	15.1	13.7	11.5
1000S200-68	50	18	16.4	13.6	16.4	14.9	13
1000S200-97	50	20.3	18.5	16.1	18.4	16.7	14.6
1000S250-54	50	16.7	14.5	11.8	15.8	14.4	11.8
1000S250-68	50	18.8	17	13.9	17.2	15.6	13.6
1000S250-97	50	21.1	19.2	16.8	19.2	17.5	15.3
1000S300-54	50	17	14.7	12	16.1	14.6	12
1000S300-68	50	19.3	17.3	14.1	17.5	15.9	13.9
1000S300-97	50	21.8	19.8	17.3	19.8	18	15.7
1200S162-68	50	19.3	16.7	13.7	18.1	16.4	13.7
1200S162-97	50	22.6	20.5	17.7	20.5	18.6	16.3
1200S200-68	50	20.8	18.1	14.8	18.8	17.1	14.8
1200S200-97	50	23.5	21.4	18.7	21.4	19.4	16.9
1200S250-68	50	21.5	18.7	15.3	19.5	17.7	15.3
1200S250-97	50	24.4	22.2	19.4	22.2	20.1	17.6
1200S300-68	50	22	19	15.6	20.3	18.4	15.6
1200S300-97	50	25.2	22.9	20	22.9	20.8	18.2
1400S162-68	50	20.5	17.8	14.5	20.4	17.8	14.5
1400S162-97	50	25.5	23.2	18.9	23.2	21.1	18.4
1400S200-68	50	22.3	19.3	15.8	21.2	19.3	15.8
1400S200-97	50	26.6	24.1	20.4	24.1	21.9	19.1
1400S250-68	50	23.2	20.1	16.4	21.9	19.9	16.4
1400S250-97	50	27.5	25	21.2	25	22.7	19.8
1400S300-68	50	23.7	20.5	16.7	22.3	20.3	16.7
1400S300-97	50	28.3	25.7	21.7	25.7	23.3	20.4

1. Spans are based on continuous support of compression flange over the full length of the joist.
2. Joist deflection limitations are based upon L/240 for the total load (TL) and L/360 or L/480 for live load (LL).
3. Joists must be braced against rotation at all supports.
4. The yield stress (33ksi or 50ksi) used to calculate tabulated values is indicated in each table.
5. Span tables are calculated per CSSBI 58-2018 Lightweight Steel Framing Member Selection Tables.
6. Stud distortional buckling based on an assumed K<sub>φ</sub>=0.
7. Web punchouts are not considered for shear.
8. The tables do not include web crippling calculations. Web crippling and web stiffeners requirements to be designed as per CSSBI 58-2018 and Section G-5 of S136-16.

# FLOOR JOIST SPAN LIMITATIONS

Joist Member	Yield Strength Fy(ksi)	25 psf Dead Load 100 psf Live Load					
		TL Deflection = L/240, LL Deflection = L/360			TL Deflection = L/240, LL Deflection = L/480		
		Spacing (in) o.c.			Spacing (in) o.c.		
		12	16	24	12	16	24
800S162-43	33	9.8	8.5	0	9.8	8.5	0
800S162-54	50	13.1	11.4	9.3	12.2	11	9.3
800S162-68	50	14.5	13.2	10.8	13.2	11.9	10.5
800S162-97	50	16.1	14.7	12.8	14.7	13.3	11.6
800S200-43	33	10.6	9.1	0	10.6	9.1	0
800S200-54	50	14.1	12.2	9.9	12.9	11.7	9.9
800S200-68	50	15.2	13.8	11.6	13.8	12.6	10.9
800S200-97	50	16.9	15.4	13.5	15.4	13.9	12.2
800S250-43	33	10.8	9.4	0	10.8	9.4	0
800S250-54	50	14.4	12.5	10.2	13.2	12	10.2
800S250-68	50	15.8	14.4	11.9	14.4	13	11.4
800S250-97	50	17.7	16.1	14	16.1	14.6	12.7
800S300-43	33	10.9	9.5	0	10.9	9.5	0
800S300-54	50	14.6	12.6	10.3	13.6	12.3	10.3
800S300-68	50	16.2	14.7	12.1	14.7	13.4	11.7
800S300-97	50	18.3	16.6	14.5	16.6	15.1	13.2
1000S162-54	50	14.6	12.6	10.3	14.5	12.6	10.3
1000S162-68	50	17.2	14.9	12.2	15.7	14.3	12.2
1000S162-97	50	19.4	17.7	15.4	17.6	16	14
1000S200-54	50	15.7	13.6	11.1	15.1	13.6	11.1
1000S200-68	50	18	16	13.1	16.4	14.9	13
1000S200-97	50	20.3	18.5	16.1	18.4	16.7	14.6
1000S250-54	50	16.2	14	11.3	15.8	14	11.3
1000S250-68	50	18.8	16.4	13.4	17.2	15.6	13.4
1000S250-97	50	21.1	19.2	16.8	19.2	17.5	15.3
1000S300-54	50	16.4	14.2	11.4	16.1	14.2	11.4
1000S300-68	50	19.3	16.7	13.7	17.5	15.9	13.7
1000S300-97	50	21.8	19.8	17.3	19.8	18	15.7
1200S162-68	50	18.6	16.1	13.2	18.1	16.1	13.2
1200S162-97	50	22.6	20.5	17	20.5	18.6	16.3
1200S200-68	50	20.2	17.5	14.2	18.8	17.1	14.2
1200S200-97	50	23.5	21.4	18.3	21.4	19.4	16.9
1200S250-68	50	20.8	18	14.7	19.5	17.7	14.7
1200S250-97	50	24.4	22.2	18.9	22.2	20.1	17.6
1200S300-68	50	21.2	18.4	15	20.3	18.4	15
1200S300-97	50	25.2	22.9	19.4	22.9	20.8	18.2
1400S162-68	50	19.8	17.1	0	19.8	17.1	0
1400S162-97	50	25.5	22.4	18.3	23.2	21.1	18.3
1400S200-68	50	21.5	18.6	15.2	21.2	18.6	15.2
1400S200-97	50	26.6	24.1	19.7	24.1	21.9	19.1
1400S250-68	50	22.4	19.4	15.8	21.9	19.4	15.8
1400S250-97	50	27.5	25	20.5	25	22.7	19.8
1400S300-68	50	22.9	19.8	16.2	22.3	19.8	16.2
1400S300-97	50	28.3	25.7	20.9	25.7	23.3	20.4

1. Spans are based on continuous support of compression flange over the full length of the joist.
2. Joist deflection limitations are based upon L/240 for the total load (TL) and L/360 or L/480 for live load (LL).
3. Joists must be braced against rotation at all supports.
4. The yield stress (33ksi or 50ksi) used to calculate tabulated values is indicated in each table.
5. Span tables are calculated per CSSBI 58-2018 Lightweight Steel Framing Member Selection Tables.
6. Stud distortional buckling based on an assumed  $K\phi=0$ .
7. Web punchouts are not considered for shear.
8. The tables do not include web crippling calculations. Web crippling and web stiffeners requirements to be designed as per CSSBI 58-2018 and Section G-5 of S136-16.



# FLOOR JOIST SPAN LIMITATIONS

Joist Member	Yield Strength F <sub>y</sub> (ksi)	35 psf Dead Load 100 psf Live Load					
		TL Deflection = L/240, LL Deflection = L/360			TL Deflection = L/240, LL Deflection = L/480		
		Spacing (in) o.c.			Spacing (in) o.c.		
		12	16	24	12	16	24
800S162-43	33	9.5	8.3	0	9.5	8.3	0
800S162-54	50	12.7	11	8.9	12.2	11	8.9
800S162-68	50	14.5	12.8	10.5	13.2	11.9	10.5
800S162-97	50	16.1	14.7	12.8	14.7	13.3	11.6
800S200-43	33	10.2	8.8	0	10.2	8.8	0
800S200-54	50	13.6	11.8	9.6	12.9	11.7	9.6
800S200-68	50	15.2	13.8	11.2	13.8	12.6	10.9
800S200-97	50	16.9	15.4	13.5	15.4	13.9	12.2
800S250-43	33	10.5	9.1	0	10.5	9.1	0
800S250-54	50	13.9	12	9.8	13.2	12	9.8
800S250-68	50	15.8	14.1	11.5	14.4	13	11.4
800S250-97	50	17.7	16.1	14	16.1	14.6	12.7
800S300-43	33	10.6	9.2	0	10.6	9.2	0
800S300-54	50	14.1	12.2	10	13.6	12.2	10
800S300-68	50	16.2	14.3	11.7	14.7	13.4	11.7
800S300-97	50	18.3	16.6	14.5	16.6	15.1	13.2
1000S162-54	50	14.1	12.2	10	14.1	12.2	10
1000S162-68	50	16.6	14.4	11.8	15.7	14.3	11.8
1000S162-97	50	19.4	17.7	15	17.6	16	14
1000S200-54	50	15.2	13.2	10.7	15.1	13.2	10.7
1000S200-68	50	17.9	15.5	12.6	16.4	14.9	12.6
1000S200-97	50	20.3	18.5	16.1	18.4	16.7	14.6
1000S250-54	50	15.6	13.5	10.9	15.6	13.5	10.9
1000S250-68	50	18.4	15.9	13	17.2	15.6	13
1000S250-97	50	21.1	19.2	16.6	19.2	17.5	15.3
1000S300-54	50	15.8	13.7	10.9	15.8	13.7	10.9
1000S300-68	50	18.7	16.2	13.2	17.5	15.9	13.2
1000S300-97	50	21.8	19.8	16.9	19.8	18	15.7
1200S162-68	50	18	15.6	12.7	18	15.6	12.7
1200S162-97	50	22.6	20.2	16.5	20.5	18.6	16.3
1200S200-68	50	19.5	16.9	13.8	18.8	16.9	13.8
1200S200-97	50	23.5	21.4	17.7	21.4	19.4	16.9
1200S250-68	50	20.2	17.5	14.3	19.5	17.5	14.3
1200S250-97	50	24.4	22.2	18.3	22.2	20.1	17.6
1200S300-68	50	20.5	17.7	14.5	20.3	17.7	14.5
1200S300-97	50	25.2	22.9	18.7	22.9	20.8	18.2
1400S162-68	50	19.1	16.6	0	19.1	16.6	0
1400S162-97	50	25	21.7	17.7	23.2	21.1	17.7
1400S200-68	50	20.8	18	14.7	20.8	18	14.7
1400S200-97	50	26.6	23.4	19.1	24.1	21.9	19.1
1400S250-68	50	21.6	18.7	15.3	21.6	18.7	15.3
1400S250-97	50	27.5	24.2	19.8	25	22.7	19.8
1400S300-68	50	22.1	19.2	15.4	22.1	19.2	15.4
1400S300-97	50	28.3	24.8	20.3	25.7	23.3	20.3

1. Spans are based on continuous support of compression flange over the full length of the joist.
2. Joist deflection limitations are based upon L/240 for the total load (TL) and L/360 or L/480 for live load (LL).
3. Joists must be braced against rotation at all supports.
4. The yield stress (33ksi or 50ksi) used to calculate tabulated values is indicated in each table.
5. Span tables are calculated per CSSBI 58-2018 Lightweight Steel Framing Member Selection Tables.
6. Stud distortional buckling based on an assumed  $K\phi=0$ .
7. Web punchouts are not considered for shear.
8. The tables do not include web crippling calculations. Web crippling and web stiffeners requirements to be designed as per CSSBI 58-2018 and Section G-5 of S136-16.



# BAILEY<sup>®</sup>

METAL PRODUCTS LIMITED

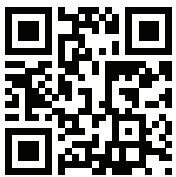

## BAILEY C JOIST SPAN TABLES AND DETAILS

[sales@bmp-group.com](mailto:sales@bmp-group.com) • [www.bmp-group.com](http://www.bmp-group.com)



JF07IN19-1000

### MONTREAL

525 Avenue Edward VII  
Dorval, QC H9P 1E7  
Tel. (514) 735-3455  
800-263-3455  
Fax. (514) 735-5052

### TORONTO

1 Caldari Road  
Concord, ON L4K 3Z9  
Tel. (905) 738-9267  
800-668-2154  
Fax. (905) 738-5712

### CALGARY

3924 27th Street NE  
Calgary, AB T1Y 5K7  
Tel. (403) 248-3536  
800-665-2013  
Fax. (403) 248-0288

### EDMONTON

5710 Roper Road NW  
Edmonton, AB T6B 3G7  
Tel. (780) 462-5757  
800-563-1751  
Fax. (780) 450-3378

### VANCOUVER

7715 Anvil Way  
Surrey, BC V3W 6A2  
Tel. (604) 590-5100  
800-818-2666  
Fax. (604) 590-5105