

BXUVC.F918 - FIRE-RESISTANCE RATINGS

BXUVC - Fire-resistance Ratings

See General Information for Fire-resistance Ratings

Design No. F918

May 21, 2018

Unrestrained Assembly Rating - 2 Hr.

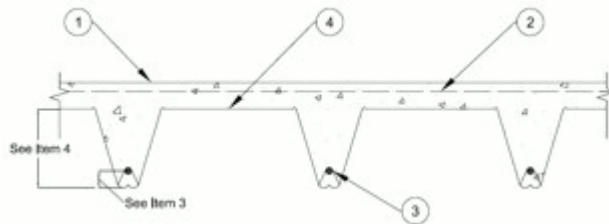

1. **Normal Weight or Lightweight Concrete** — Normal weight concrete, carbonate or siliceous aggregate, $2400 \pm 50 \text{ kg/m}^3$ unit weight. Lightweight concrete - expanded shale or slate aggregate by rotary-kiln method or expanded clay aggregate by rotary-kiln or sintered-grade method, vibrated, 4 to 7 per cent entrained air, $1750 \pm 50 \text{ kg/m}^3$ unit weight. Min. concrete compressive strength 30 MPa, vibrated. See Item 4 for thicknesses.

• 2. **Welded Wire Fabric** — 152 by 152 - Min wire thickness MW 18.7 / MW18.7 steel wire mesh.

3. **Rib Reinforcement** — Steel reinforcement designed in accordance with ACI 318 latest specifications. Min. 10 mm rebar. Min concrete cover below the steel reinforcement shall be 40 mm. Reinforcement support chairs spaced at max 1055 mm OC.

• 4. **Steel Floor Units (CHWXC)** — 120 mm, 203 or 225 mm deep composite, galv steel units. Min thickness 0.953 mm (20 MSG). Side joints of adjacent units fully overlapping, fastened together by using 30 mm. long self-drilling, self-tapping steel screws driven through Shear-Bond Clips (not shown) at 350 mm. OC. Steel end closures flashings (not shown) made of min thickness 1.37 mm (16 MSG) galv steel, fixed to the steel work before decking is placed. Consult the deck manufacturer for comprehensive load tables and design parameters referencing this UL Design.

BAILEY METAL PRODUCTS LTD — Type COMSLAB™ 120, COMSLAB™ 210, or COMSLAB™ 225

Unrestrained Rating, Hr	2	2	1-1/2	1
Concrete Topping, from Deck Crests, mm	110	83	90	64
Concrete Type	NW	LW	NW	NW or LW
COMSLAB Deck Type (s)	120, 210, 225	120, 210, 225	120, 210, 225	120, 210, 225

Last Updated on 2018-05-21

The appearance of a company's name or product in this database does not in itself assure that products so identified have been manufactured under UL's Follow-Up Service. Only those products bearing the UL Mark should be considered to be Certified and covered under UL's Follow-Up Service. Always look for the Mark on the product.

UL permits the reproduction of the material contained in the Online Certification Directory subject to the following conditions: 1. The Guide Information, Assemblies, Constructions, Designs, Systems, and/or Certifications (files) must be presented in their entirety and in a non-misleading manner, without any manipulation of the data (or drawings). 2. The statement "Reprinted from the Online Certifications Directory with permission from UL" must appear adjacent to the extracted material. In addition, the reprinted material must include a copyright notice in the following format: "© 2019 UL LLC"